

# 10.8v Li-ion Cordless POWERstick

## User Manual

## THANK YOU

Thank you for investing in a CEL product. The 10.8v Li-Ion Cordless POWERstick has been engineered and made to demanding high quality standards; ease of operation and safety have taken a major role in development. Proper care of your product will give you years of trouble-free use.

Normal wear and tear, including accessory wear, is not covered under guarantee. The product is guaranteed for **domestic use** against manufacturing faults for a period of 12 months (for additional guarantee period (if any) please refer to the store or agent from which you purchased the product or contact the nearest authorized dealer). This product is not guaranteed for HIRE purposes.

If you have any questions, please contact us at:

[sales@cel-global.com](mailto:sales@cel-global.com)

It is possible to download updated user manuals, view demonstration videos and find information about new products at: [www.cel-global.com](http://www.cel-global.com)

**Warning:** User must read and understand the user manual before using the product to reduce the risk of injury. Failure to follow all instructions may result in electric shock, fire and/or serious personal injury. The product must be used only for its prescribed purpose. Any use other than those mentioned in this manual will be considered a case of misuse. The manufacturer shall NOT be liable for any damage or injury resulting from such cases of misuse, use of force, partially or completely dismantled appliances.



# Contents

- 1.0 Important Safety Notes
- 2.0 Unpacking
- 3.0 POWERstick Functions
- 4.0 Battery and Charging
- 5.0 Safety Notes Before Cutting

## GETTING STARTED

- 6.0 Hedge Trimmer
- 7.0 Cutting a Hedge
- 8.0 Grass Trimmer
- 9.0 Trimming Grass
- 10.0 Brush and Rake

## CUTTING

- 11.0 FAQ
- 12.0 Maintenance, Storage, Environment
- 13.0 Technical Specifications

## CARE

**Description of symbols** The rating plate on your tool may show symbols. These represent important information about the product or instructions on its use.



General Hazard



Read Instructions



Keep Dry



Protect Eyes, Ears, Lungs



Keep Bystanders Away



Flying Debris



Sharp Blades

**Breathing protection should be worn when cutting some plants.**

**Use at a distance of at least 5m from other people.**

**Conforms to relevant standards for electromagnetic compatibility.**

To use this tool properly, you must observe the safety limitations, the assembly instructions and the operating instructions to be found in this Manual. All persons who use and service this machine must be acquainted with this Manual and must be informed about it's potential hazards. Children and infirm people must not use this tool. Children should be supervised at all times if they are in the area in which the tool is being used. It is also imperative that you observe the accident prevention regulations in force in your area. The same applies for general rules of occupational health and safety.

The manufacturer shall not be liable for any changes made to the tool nor for any damage resulting from such changes.

**Even when the tool is used as prescribed it is not possible to eliminate all residual risk factors. The following hazards may arise in connection with the tool's construction and design:**

**Contact with the blade.**

**Kickback.**

**Blade fracture.**

**Catapulting of blade pieces and cuttings.**

**Damage to eyes if effective safety glasses or shield are not worn.**

**Damage to ears if effective ear protection is not worn.**

**Injury or illness caused by inhalation of cuttings if breathing protection is not sufficient.**

**Always prevent activation of the tool before making any adjustments or performing maintenance.**

**Store tools safely.** When not in use, tools should be stored in a dry, high place or locked up out of reach.

**Do not force the tool.** The tool will do the job better and safer working at the rate for which it was designed.

**Use the correct tool for the job.** Do not force small tools or attachments to do the job best handled by a heavier duty tool. Never use a tool for a purpose other than that for which it was intended.

**Dress correctly.** Do not wear loose clothing or jewellery. They can be caught in moving parts. Rubber gloves and non-slip footwear are recommended while working outdoors. If you have long hair, wear a protective hair covering.

**Use safety accessories.** Safety glasses and ear muffs should always be worn.

**Do not overreach.** Keep your footing secure and balanced at all times.

**Look after your tools.** Keep tools clean and sharp for better and safer performance. Follow the instructions regarding lubrication and accessory changes. Keep tool handles dry, clean and free from oil and grease.

**Disable idle tools.** Prevent accidental starting of the tool before servicing and when the tool is not in use.

**Stay alert.** Watch what you are doing, use common sense. Do not operate a power tool when you are tired.

**Check for damaged parts.** Before using a tool, check that there are no damaged parts. If a part is slightly damaged, carefully determine it will operate properly and perform its intended function. Check for alignment of moving parts, binding of moving parts, breakage of parts, proper mounting and any other conditions that may affect the operation of the tool. A guard or other part that is damaged should be properly repaired or replaced by an authorized service facility, unless otherwise indicated in this Instruction Manual.

**Defective switches must be replaced by an authorised service facility. Do not use a tool if the switch does not turn the tool on and off correctly.**

**Guard against electric shock.** Prevent contact with grounded objects such as water pipes.

**Use only approved parts.** When servicing, use only identical replacement parts. Use an authorised service facility to fit replacement parts.

**Do not let tool run unattended.** Always wait until your power tool has come to a complete stop and remove the battery before leaving it.

**WARNING.** The use of an accessory or attachment, other than those recommended in this Instruction Manual, may present a risk of personal injury.

The tool must be used only for its prescribed purpose. Any use other than those mentioned in this Manual will be considered a case of misuse. The user and not the manufacturer shall be liable for any damage or injury resulting from such cases of misuse.

### **Additional safety rules for Grass and Hedge trimmers**

Do not use the trimmer in the rain or in a damp area.

Keep hands and fingers well away from the cutting area.

Wear work gloves, eye, ear and breathing protection, solid shoes and trousers while using this trimmer.

Always grasp both handles when operating the unit, only operate the machine in its intended orientation.

Turn the machine off when you have finished cutting, before cleaning or if you have been interrupted and take care not to accidentally activate.

This trimmer has been designed to cut soft, new growth and should not be used on branches, hard wood or other forms of cutting.

Do not attempt to free debris or check the cutting blades before first switching off the machine.

Check the area to be cut for stones and anything that may be flung by the tool. Remove wire and string as it may damage the trimmer.

Do not cut against hard objects, this may damage the tool and cause injury.

Never use the machine without the safety devices properly fitted and undamaged

**WARNING,** the guard is for the safety of the operator and bystanders, never remove it while operating the machine.

Never touch or go near the cutting area while the motor is still turning, the tool may take a few seconds to slow down after the trigger is released.

Only use blades as supplied or identical replacements designed specifically for this tool.

Only cut if lighting levels are adequate.

Do not activate the tool if there is debris in the vents or otherwise obstructing operation.

Release trigger when moving between work areas, gravel paths can create flying debris danger.

If the machine appears to have any fault or makes any unusual sounds please consult the manual a service centre or your retailer.

If you are interrupted while operating the trimmer, complete the process and switch off before looking up.

**Wear goggles, Wear ear muffs, Wear breathing protection,  
Wear work boots, Wear protective clothing.**

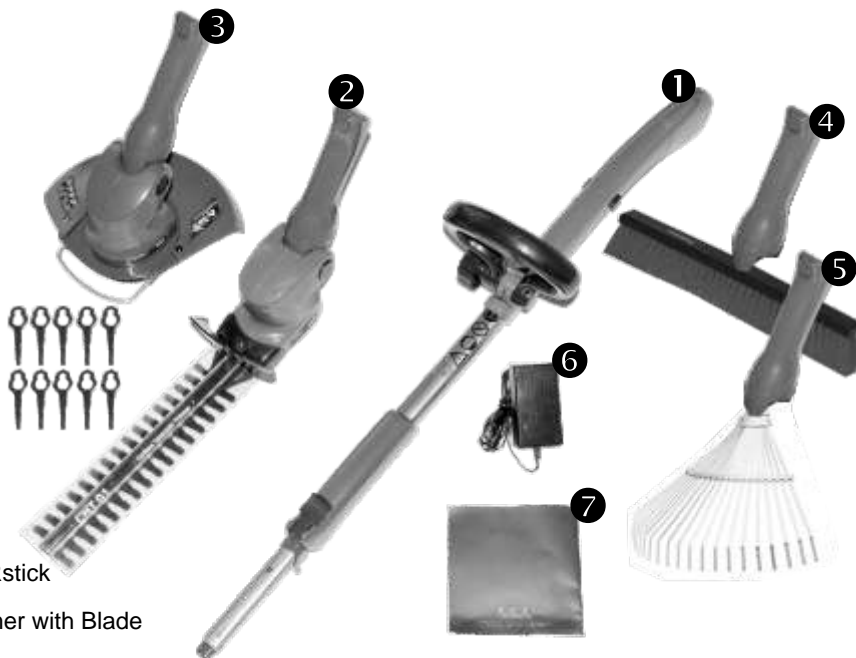

- ① PS1 POWERstick
- ② Hedge Trimmer with Blade Sheath
- ③ Grass Trimmer with spare blades
- ④ Brush
- ⑤ Rake
- ⑥ Charger Unit
- ⑦ This User Manual

**NOTE**

Due to modern mass production techniques, it is unlikely that your power tool is faulty or that a part is missing. If you find anything wrong, do not operate the tool until the parts have been replaced or the fault has been rectified. Failure to do so could result in serious personal injury.



The POWERstick contains the battery and operating controls. It attaches to each of the tools to provide a telescopic handle and comfortable work position.



#### WARNING

**Do not allow contact with fire or water, it could cause an explosion!**

**Do not use an extension cord when charging.**

**Charge indoors only.**

**Please dispose of batteries at your local battery disposal depot.**

**To prevent explosion only use the provided charger.**

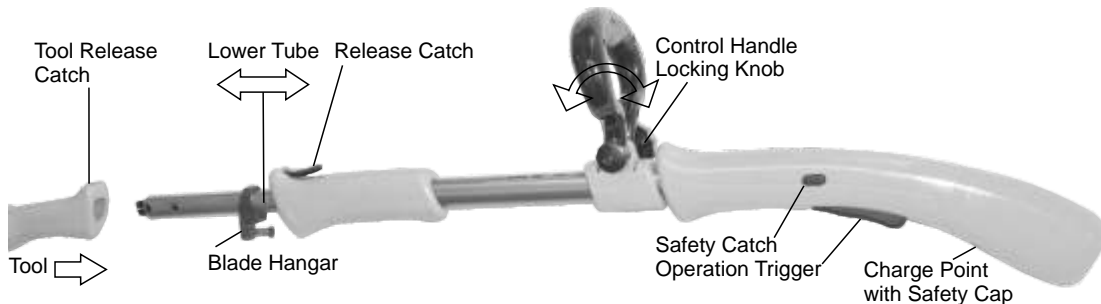

**Adjusting the length of the telescopic arm** is done by lifting the release catch and sliding the lower tube into the desired position. Lock in place by returning the release catch to its original position where it will clip into place.

**To alter the position of the control handle** first rotate the locking knob 3 or 4 turns anti clockwise to release the locking teeth, position the handle as desired and tighten the knob. The locking teeth can be worn down if the handle is not tightened correctly or the handle is forced to move without loosening the knob enough.

**To fit or remove a Tool** grip the POWERhandle firmly behind the blade hangar to prevent your hand being trapped in the mechanism. Hold the tool firmly by the upper section near the tool release catch and align with the POWERhandle. The tools can only be fitted together in the correct orientation because the tube is shaped in a specific way. **DO NOT** force the tool, if it is difficult to assemble re-align and try again. Press the lower tube into the tool so that it locks into place against the blade hangar. You may notice the tool release catch click as it locks in. To remove, press the tool release catch down and slide out, taking care not to swing the tool and hit a bystander. After fitting a tool the trigger and safety catch will feed power to that tool and allow a great range of functions. To operate the trigger you must first press the safety catch in from either the left or right side of the handle. Then, ensuring no danger to yourself or bystanders press the trigger to operate the tool.

## Battery

This product contains a fixed Lithium Ion battery, it is not removable and repairs should only be carried out by a CEL authorised repairer.

The Lithium Ion battery in this product is transported in a semi charged state and should be placed on charge for at least 5 hours before the first use.

Lithium Ion batteries can be recharged at any time during their use, there is no need to completely discharge the battery before recharging. You can use the battery for 5 minutes and place on charge with no detrimental effects. Additionally there is no need to wait for the battery to fully charge before removing from the charger.

Store the POWERstick in a stable and dry environment between 10° and 24° degrees Celsius (50° and 75° degrees F).

Excessive heat will reduce the lifetime of the battery, cooler conditions are best. The POWERstick will hold its charge for several months without charge but should never be stored flat as this may permanently damage the battery, to prevent damage place on charge at least once every 3 months.

The POWERstick will automatically shut off operation when the charge level of the battery is low, recharge immediately. If the temperature of the unit gets too high it will also shut off. Allow the POWERstick and the charger to cool.



## Charging

Power on = Green  
Charging = Red

Charged = Green  
Flashing Red = Error

1. Plug the charger unit into a safe and suitable power outlet. When the charger detects the power the light will turn green.
2. Slide the Charge Point Cap to reveal the charge point this will disable the trigger.
3. Insert the charger tip into the charge point on the POWERstick just behind the trigger (see previous page) and press in firmly. The light will turn red while the unit is charging. Charging time is typically 5 hours but the charger will indicate when the battery is ready for use. If the battery was not fully discharged in the previous use a faster charge will be possible.
4. Once the battery is charged the light on the charger will show a solid green, disconnect the charger from the POWERstick, remove the charger from the power outlet and store safely.

**If there is any doubt of normal operation of any part of this tool or the charger, de-activate and remove from any source of power immediately. Consult your retailer.**

**NEVER** pull the charger out by the cord or use if the cord is damaged in any way.

**NEVER** use any charger other than the one supplied with this product or an identical CEL replacement. The supplied battery and charger are designed to be used solely with each other and will cause damage if used with other chargers or batteries.

**NEVER** leave the battery on charge for longer than 48 hours to reduce fire risk.

Always check for danger to people, animals, and yourself before activating tools. Beware of hidden objects in, around and behind a hedge or obstruction.



Make sure bystanders are safe, do not cut if you cannot see the area being cut.

Some plants and trees contain harmful substances, always be aware of risks and take appropriate measures before beginning work.

Always wear safety equipment.



Eye, ear and breathing protection, suitable clothing and work boots.

Always disconnect the battery and ensure the motor has stopped before cleaning or making any adjustments.

Ensure the cutting blades are correctly adjusted. Do not use blades designed for other products.

Check all fittings and fixings are present and correctly fitted.



Always start the tools away from the area to be cut, attempting to cut before the trimmer reaches operating speed can damage the tool.

Before starting work run the tools briefly and check for unusual sound or vibration, and for any other signs of damage, defects or deterioration.

Some small sparks and a slight burning smell may emanate from the motor, this is normal and is due to the electronic brake.

Ensure repairs are carried out before using the trimmer or any of the accessories. Repairs should only be carried out by qualified and authorised persons, if in doubt ask your retailer.



The battery contains acids and chemicals that can be harmful if the battery is damaged it must be disposed of properly and replaced with an identical product.

If you feel any physical discomfort or pain stop work immediately.

If the battery or motor become too hot to touch stop work immediately.

Check the area to be cut for stones and anything that may be flung by the tool. Remove wire and string from the cutting area as it may damage the trimmer.



These tools are to be used for trimming soft, new growth only. Use the tool and accessories only for the applications intended. All other applications are expressly ruled out.



Read and understand all warnings and instructions before starting work.

**If any part of this product is damaged or worn in any way do not use it, consult your retailer.**

To fit the Hedge trimmer attachment first ensure the POWERstick is switched off and there is no chance that the trigger will be accidentally activated. Ensure there is no dirt or debris that will become trapped in the mechanism or foul the contacts. It is advised to keep the blade shield fitted whenever the tool is not active. Follow the tool fitting directions shown in the POWERstick section.

Extend the POWERstick as required and rotate the head to the desired orientation.

To rotate the head, press the two rotation buttons together and alter the head angle, release to lock in place. If the buttons do not pop out immediately, move the head angle slightly until they pop out, locking the head securely.

By extending the telescopic handle and tilting the trimmer head you can cut the top of a hedge without the need for a ladder. Take extra care when reaching to ensure you don't come in contact with an unseen person or object.

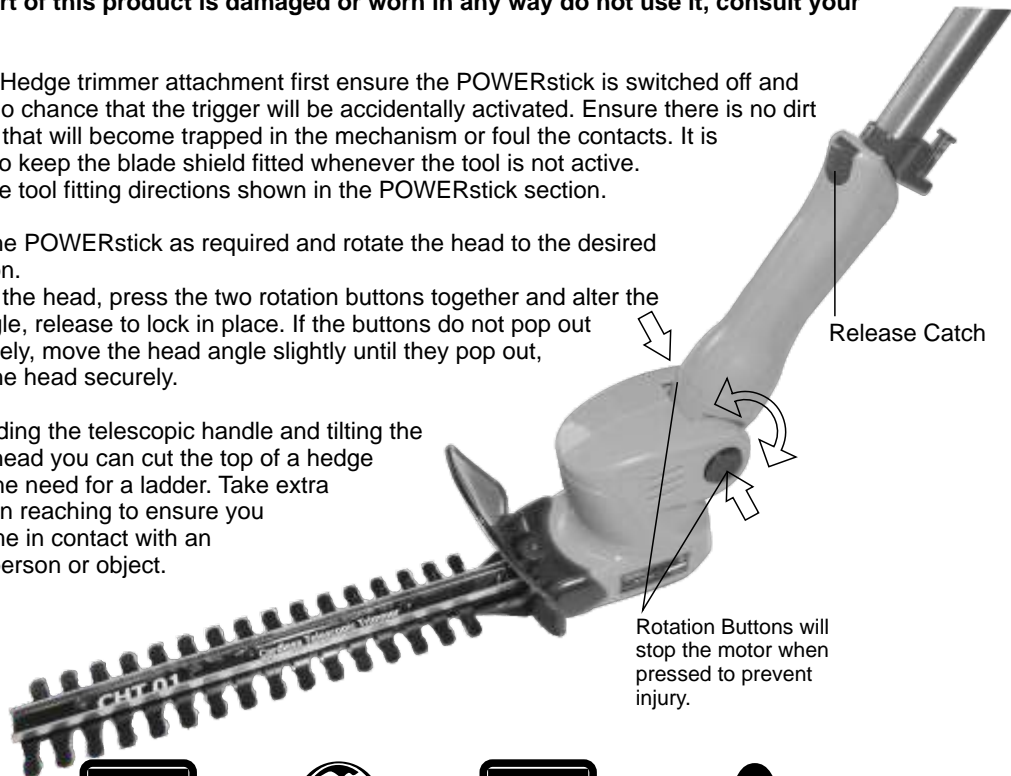

## Shaping

Trim a hedge so that it is wider at the bottom than the top.

This improves light penetration and promotes healthy growth.

Narrow the hedge approximately 100mm for every 1m in height.

A bush/shrub can be round or column shaped.

**Only cut new growth in the summer, reshape the hedge in winter.**

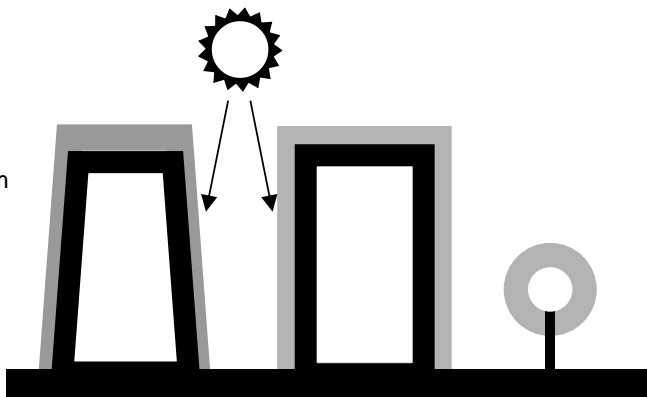

**When ready to cut, assume a secure position, check for danger to yourself or others, use two hands to hold the trimmer and switch on.**

With the trimmer running use a large arc motion to cut the hedge, by extending the telescopic handle you can make a larger arc and achieve a smoother finish.

Trim both sides of the hedge, starting at the bottom. This prevents cuttings falling into the area yet to be cut and allows a smoother action by following the natural direction of growth.

Pass the blade lightly through the surface of the hedge. Do not attempt to cut too deep or too fast.

Trim the top of the hedge from a secure position and without leaning into the hedge. Be aware of people, animals and objects on the other side of the hedge.

For neglected hedges that require cutting back substantially, use pruning shears to cut thicker branches and then finish the job with the hedge trimmer. Fit the rake attachment and tap the hedge to expose any missed branches and trim again to finish.

**For more tips, techniques and tools please visit [www.cel-garden.com](http://www.cel-garden.com)**

**If any part of this product is damaged or worn in any way do not use it, consult your retailer.**

**To fit the grass trimmer attachment** first ensure the POWERstick is switched off and there is no chance that the trigger will be accidentally activated. Ensure there is no dirt or debris that will become trapped in the mechanism or foul the contacts. See the POWERstick section for how to attach a tool.

Extend the POWERstick as required and rotate the head to the desired orientation.

To rotate the head, press the two rotation buttons together and alter the head angle, release to lock in place. If the buttons do not pop out immediately move the head angle slightly until they pop out, locking the head securely.

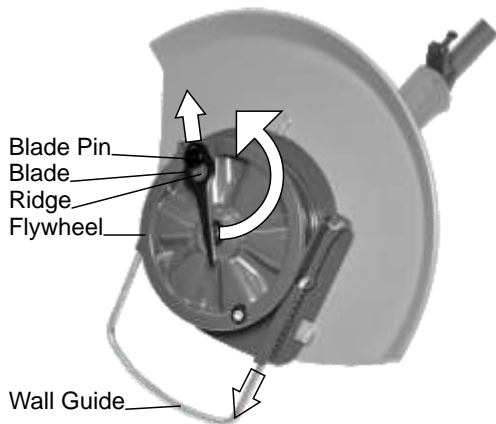

Rotation Buttons will stop the motor when pressed to prevent injury.

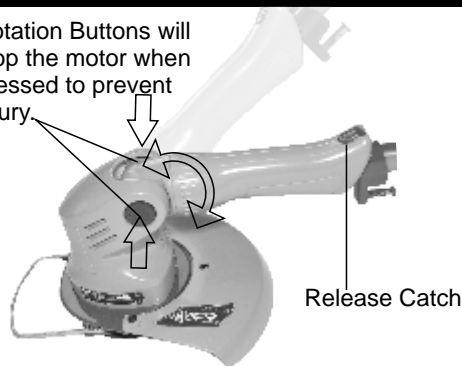

**To fit a blade**, first remove any worn or damaged blade by rotating it so the larger part of the keyhole is closer to the centre of the flywheel, push outward until the large part of the keyhole is over the blade pin and lift the blade off. Take a new blade and place the larger part of the keyhole over the blade pin, pull the blade so the smaller part of the keyhole locks over the blade pin then rotate the blade outside the flywheel making sure the ridge on the flywheel locks it in place.

New blades will cut grass more cleanly and leave grass healthier, the outer part of the cutting area has the most cutting power. Replacement blades available CEL part Number **PSTB01**. Commonly known as Safety Cutter Blades.

**The Wall Guide** will keep the blades from impacting with walls, trees and edging. To extend the guide just pull out until it locks in place, this will allow you to cut all the way to the edges without damaging them or the blade. Press the guide in to allow the blade to cut closer or for storage.

## Trimming/Clearing

Adjust the trimmer as described in the previous sections.

Start the trimmer before approaching the cutting area and allow it to reach full speed before beginning the cut.

Be aware that the tool could kick back on contact.

Stand with a good posture and be aware of your surroundings, keep both hands on the trimmer and control the trimmer with firm even pressure.

Cut larger areas of grass by swinging the trimmer in an arc across the ground. Cut small amounts with each pass so the motor is not overloaded. When clearing long grass cut the tops off first and work down in stages.

Avoiding hard objects will extend the life of the cutting blades.



## Brush and Rake

Use the rake before cutting to lift dead or long grass and on the lawn before mowing to aerate the soil and increase water absorption. Using the back of the rake to tap a cut hedge will help to reveal any missed branches and a quick trim with the HEDGEtrimmer will leave a much smoother finish. After the work is done use the rake to clean up.

The Brush will finish the clean up and leave your garden better than ever. Before mowing try dragging the brush behind you to lift the grass into the mower blades for a really smooth lawn. Brush after rain to clear dirt build up from patios and decking or sweep cobwebs and debris from walls.

**Where can I get more POWERstick accessories?**

[www.cel-garden.com](http://www.cel-garden.com) or ask your retailer.

**What size of a hedge stem will the unit cut?**

The Hedge Trimmer was designed to cut up to 8mm thickness, larger branches should be cut using secateurs or a more powerful tool like the HT1 hedge trimmer.

**The blades are not cutting cleanly, are they dull?**

Most likely there is a sap build-up between the blades. Spray a light coating of machine oil on the blades to loosen the sap. Regular lubrication will help to avoid this build up.

**Why do the grass trimmer blades break?**

Usually because of hard objects or wearing. Try to avoid solid objects. When cutting thick grass take small cuts as the outer diameter of the rotating blade will cut more efficiently than the inside. Use new blades for a better result.

**The tool wont start, what's wrong?**

a)Check the battery is charged and properly fitted. Close the Charge Point Cap, also make sure the trigger and the safety catch are working correctly. b)Remove the tool from the POWERstick and check for debris, clean accordingly. c)The Lithium Ion battery has a protection circuit to prevent it from completely discharging. The battery will provide constant power then stop rather than slowing down. Recharge fully.

**Why does my POWERstick stop sometimes?**

See c) above.

**What type of oil should I use to lubricate hedge trimmer blades?**

Just about any type of oil will work on the blades, a common spray oil works perfectly.

**Do I need to fully discharge the battery before recharging it?**

No the Li-Ion system has no memory effect so you can charge it at any time. The charge will be retained in storage for much longer than older battery technology.

**Where should I keep my Hedge Trimmer ?**

In a dry place at a stable temperature between 10°C and 24°C (50°F and 75°F).

**What should I do if my Hedge Trimmer gets wet?**

Dry fully for several days in a warm but not hot place before trying to charge or use.

**How can I get my Hedge Trimmer repaired if it is damaged?**

Contact your retailer.

**Where do I find my serial number?**

On the left hand side of the PS1 body.

**Where can I get replacement parts, advice or help?**

Ask at your retailer or visit

[www.cel-garden.com](http://www.cel-garden.com)

**How long is the warranty and what is covered?**

Please see inside cover

**WARNING**, Switch off and remove the battery before carrying out any maintenance on the tool.

## **Lubrication**

After each use, carefully clean the hedge trimmer blades with a brush and lightly lubricate with general purpose oil or spray lubricant. Ask your dealer for suitable products.

## **General inspection**

Regularly check that all the fixing screws are present and tight. They may vibrate loose over time.

Keep the tool's air vents unclogged and clean at all times.

Remove dust and dirt regularly.

Cleaning is best done with compressed air or a rag.

Never use caustic agents to clean plastic parts.

**CAUTION**, Water must never come into contact with the tool.

## **Environment**

When the time comes to dispose of this product please consider the environment and take it to a recognised recycling facility instead of disposing with general household waste.

The POWERstick uses a Lithium Ion (Li-Ion) battery which must be disposed of properly.

Call your local council, civic amenity site, or recycling centre for information on the recycling and disposal of electrical products and Lithium Ion (Li-Ion) batteries.

## **Storage**

Store the tool, instruction manual and accessories in a secure, dry place. In this way you will always have all the information and parts ready to hand.

**Never Store the POWERstick With a Flat Battery.**

**The battery should ideally be stored between 10°C and 24°C (50°F) and (75°F).**

Hedge Trimmer Blade Length and Hardness - 230mm / approx. 9" 48HRC  
Hedge Trimmer operating time with full battery - 50 minutes with no load  
Hedge Trimmer Blade Oscillating Speed - 1200 rpm  
Hedge Trimmer sound Pressure Level (dB(A)) - 90dB

Grass Trimmer Cutting Diameter - 220mm / approx. 9"  
Grass Trimmer operating time with full battery - 40 minutes with no load  
Grass Trimmer flywheel rotation Speed - 8000rpm with no load  
Grass Trimmer Sound Pressure Level (dB(A)) - 90dB

Battery operating voltage - 10.8v (3 Cells)  
Battery makeup - Lithium Ion (Li-ion) 1300mAh  
Charging period for fully discharged battery - approx. 1 hour  
Charger Input - 100-240vAC 50/60Hz  
Charger Output - 12.6V DC 0.8A  
Boxed Dimensions - 1075x175x137mm  
- approx. (42x7x5")  
Boxed Weight - 2Kg (4.4lbs)  
Product Code - PS1

**If you experience any problems with the product please contact**  
email: [sales@cel-global.com](mailto:sales@cel-global.com)  
[www.cel-global.com](http://www.cel-global.com)



**GENERAL HAZARD  
SAFETY ALERT**



**BEWARE OF FLYING  
OBJECTS AND DEBRIS**



**READ INSTRUCTION MANUAL**



**KEEP BYSTANDERS AWAY**

**CEL**  
C Enterprise Ltd

C Enterprise Limited [www.cel-global.com](http://www.cel-global.com) [info@cel-global.com](mailto:info@cel-global.com)  
UK • HK • USA • China • Europe • Australia • Japan